

Owners Manual

Product Code: TQ18-0300

**MADE FOR THE
TRADE**

TQ TRADEQUIP
the trusted brand in equipment

**160KG TOP
SIDE CREEPER**



Weight Capacity (KG)	Min/Max Height (mm)	Platform Dimensions (mm)	Assembled Dimensions (mm)
160	1210 mm 1670 mm	300 x 450	1380 x 880 x 1700

TQB

TQB Brands Pty Ltd

www.tqbbrands.com.au

CONTENTS

CONTENTS	Page 2
WARNING INFORMATION	Page 2
ASSEMBLY	Page 6
OPERATION	Page 9
PREVENTATIVE MAINTENANCE	Page 11
STORAGE	Page 13
PARTS LIST	Page 14
WARRANTY	Page 15

WARNING INFORMATION



IMPORTANT:

READ ALL INSTRUCTIONS BEFORE USE

Whilst every effort has been made to ensure accuracy of information contained in this manual, the TQB Brands Pty Ltd policy of continuous improvement determines the right to make modifications without prior warning.



PPE Required



Pinch Hazards



Fall Hazards

WARNING INFORMATION

DANGER: RISK OF DEATH OR SERIOUS INJURY FROM FALLS, COLLAPSE, OR TIP-OVER

This foldable topside creeper is a specialized piece of equipment for safe leaning access to vehicle engine bays and topsides.

Misuse, overloading, or failure to follow instructions WILL result in serious personal injury or death.

WARNING

Read, understand, and follow ALL instructions, warnings, and precautions in this manual before assembly, use, inspection, or maintenance.

If you sell or transfer the creeper, include this manual with it.

WARNING INFORMATION cont.



IMPORTANT: READ ALL INSTRUCTIONS BEFORE USE



WORK AREA SAFETY

- Operate in a safe, clean, well-lit, level, and dry environment. Keep the area free of distractions, shadows, obstructions, debris, oil, grease, or trip hazards.
- Ensure the surface is smooth, stable, and capable of supporting the total load (user + tools + creeper). Do NOT use on slopes, uneven floors, ramps, gratings, wet/damp areas, condensation-prone locations, or outdoors in adverse weather.
- Keep children, bystanders, and unauthorized persons away during use and storage. Store the creeper in a dry, secure location out of children's reach.

PERSONAL SAFETY AND PPE

WARNING! Wear appropriate personal protective equipment (PPE) for the task.

- Always wear impact-resistant safety goggles or glasses providing front and side protection.
- Wear suitable gloves to protect against sharp edges, vibration, or work materials.
- Use non-slip, steel-toe safety footwear to maintain footing, prevent slips, and protect against falling objects.
- Wear close-fitting clothing and any additional protective gear suitable for the automotive work environment (e.g., to avoid snagging on engine parts).
- Do NOT use if tired, under the influence of alcohol, drugs, or medications that impair balance, judgement, alertness, or coordination. Do NOT use if you have balance issues, fainting spells, or any medical condition affecting safe climbing/working at height.

PERSONAL PRECAUTIONS

- Maintain proper footing and balance at all times. Do NOT overreach—keep your body centered and move the creeper if needed.
- Control your movements to avoid shock loads or sudden shifts.
- Do NOT let familiarity with the product replace strict adherence to these safety rules—incorrect or unsafe use can cause serious injury.

WARNING INFORMATION cont.



SPECIFIC SAFETY PRECAUTIONS FOR THIS TOPSIDE CREEPER



WARNING! Failure to comply with these rules can cause death or serious injury.

1. This creeper is designed ONLY for leaning chest-supported access to vehicle engine bays/topsides. It is NOT a ladder, step stool, scaffold, general platform, or transport device. Do NOT modify, alter, or use for unintended purposes.
2. Maximum capacity: 160KG – includes your full body weight + ALL tools, equipment, parts, personal items, and any applied torque/forces. NEVER exceed this limit—overloading can cause collapse.
3. ALWAYS lock the braked casters BEFORE climbing, adjusting, working, or descending and for storage.
4. ALWAYS ensure the height adjustment mechanism (bar/pins) is securely engaged in a position slot BEFORE use. Adjust ONLY when casters are locked, all wheels on the ground, and no load applied—hold firmly to prevent sudden drops or pinches.
5. Face the creeper when climbing up/down. Use both hands, maintain three points of contact, and keep body centered between rails.
6. Lean gently onto the chest pad for support—do NOT jump, fall, sit, stand, kneel, or apply shock loads to the pad or any non-load-bearing part.
7. Do NOT use over a running/hot engine, near moving parts, exhaust, live electrical, or in damp/wet conditions.
8. Inspect BEFORE EVERY use: Check for damage, loose/missing fasteners, worn parts, faulty casters/locks, or adjustment issues. Do NOT use if damaged—repair/replace immediately.
9. Do NOT move while occupied. Keep hands/fingers clear during adjustments.
10. Do NOT exceed one user at a time.

SAVE THESE INSTRUCTIONS

Retain this manual. If lost, contact the manufacturer/supplier for a replacement. Proper use and maintenance are your responsibility.

ASSEMBLY

Assembly

- Assemble the legs (2) to the base frame (1).
- Attach the locking caster wheels (3) to the rear of the base frame.
- Attach the 35mm stem caster wheels (11) to the front of the base frame.
- Attach the 45mm stem caster wheels (7) to the end of the legs.

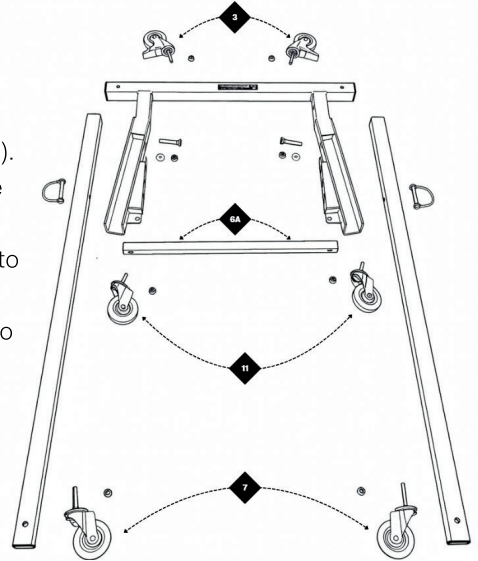

- Assemble the external ladder frame (5A) and ladder angle support (6B) together.
- Affix the ladder angle support assembly to the base frame as shown below.

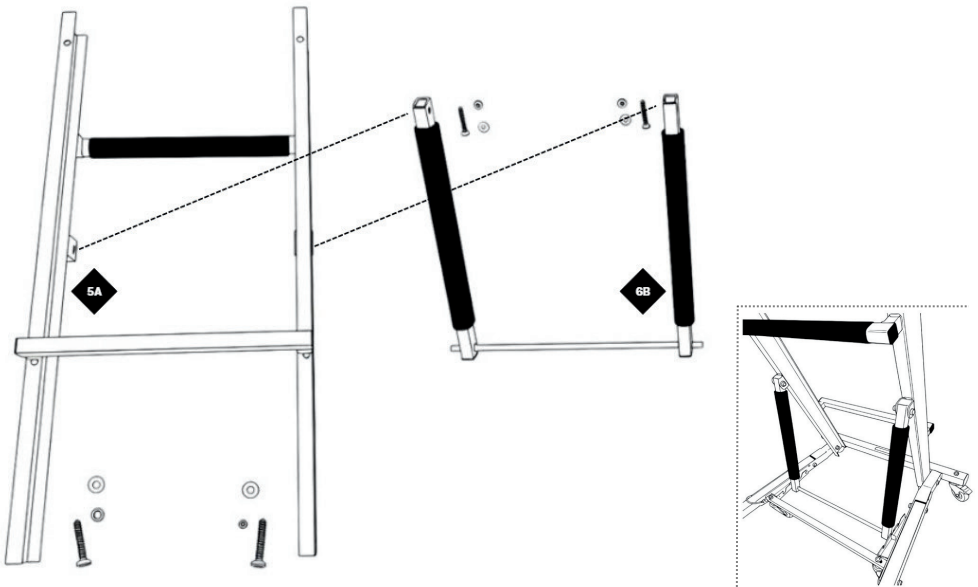

ASSEMBLY cont.

- Install the angle adjustment brackets (12) over the top of the ladder angle support bar to create a secure enclosure.

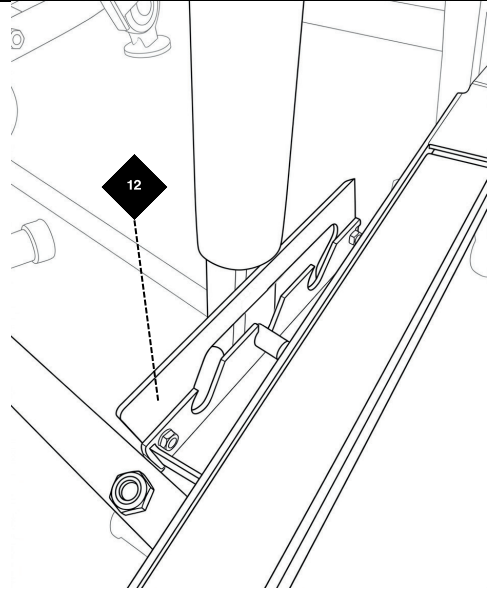
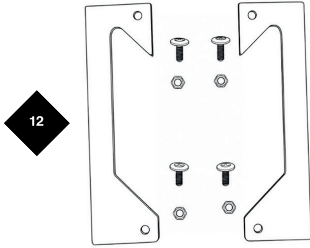

- Install the ladder (5B) into the ladder frame (5A)
- Secure the ladder with 2x D-shaped locking pins (4)

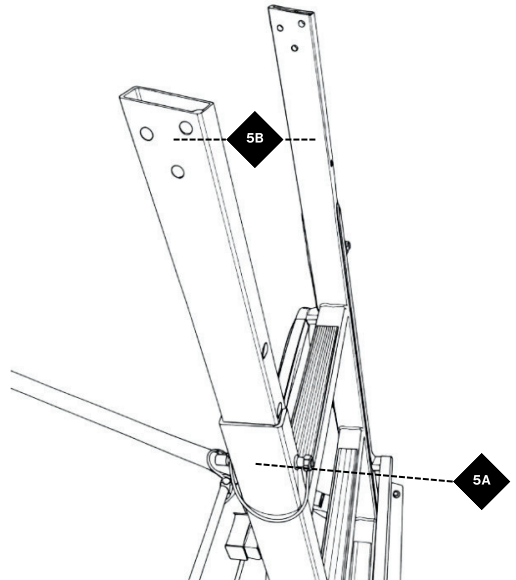
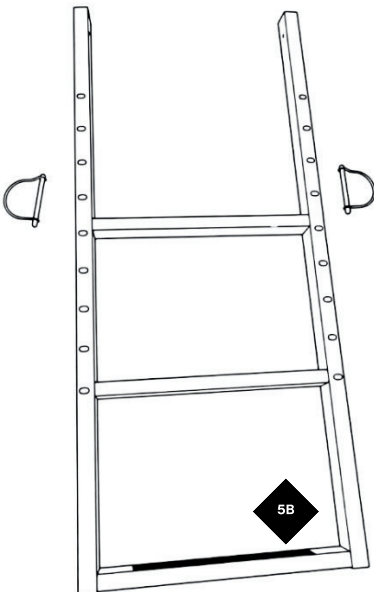

ASSEMBLY cont.

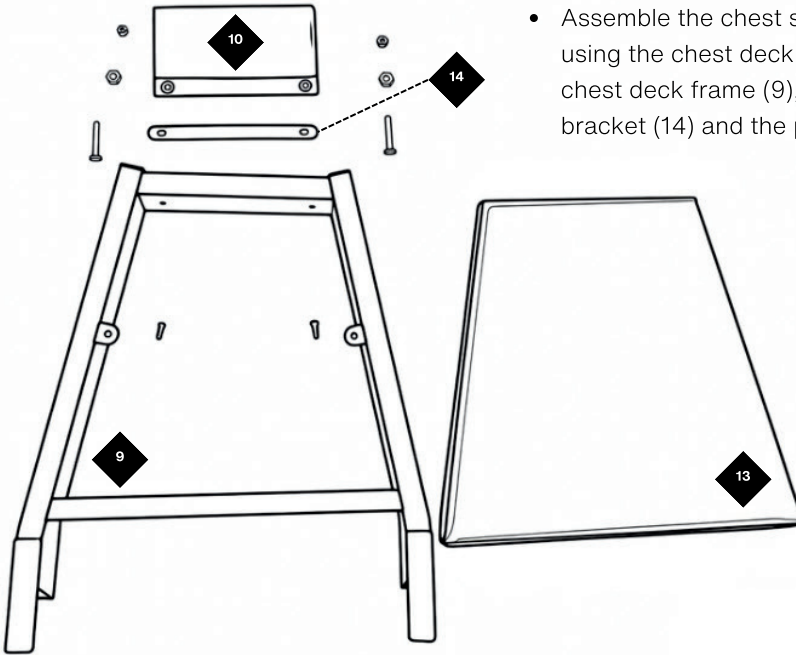

- Assemble the chest support assembly using the chest deck pad (13), the chest deck frame (9), the pouch bracket (14) and the pouch (10).

- Install the chest support assembly onto the ladder.
- Install the protective covers over the corners and mounting hardware.

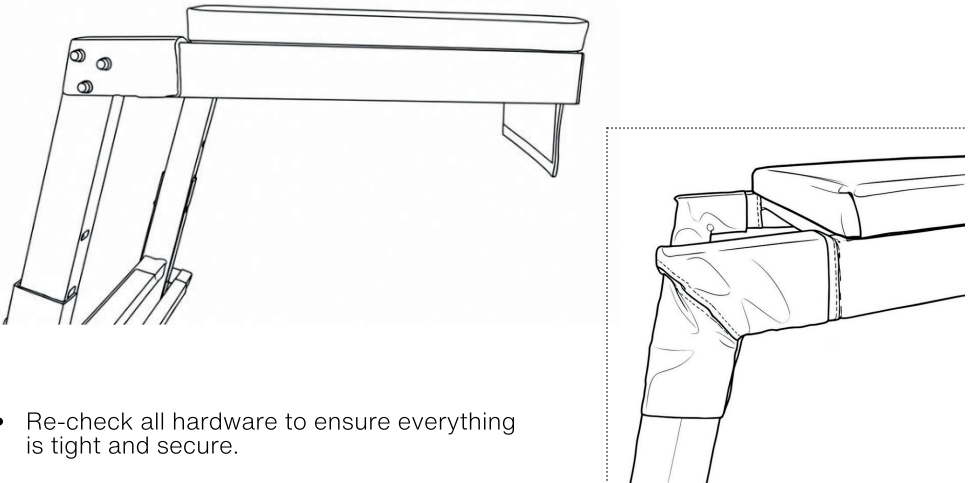

- Re-check all hardware to ensure everything is tight and secure.

OPERATION

OPERATION

This topside creeper is designed solely as a stable, leaning support platform for safe access to vehicle engine bays. It is not a ladder, step stool, scaffold, general work platform, or transport device. Read and understand all safety instructions before use.

INTENDED USE

- Lean chest onto the padded deck while standing on the steps to reach over engine compartments or vehicle tops.
- Use only for light-duty reaching, inspection, or minor tasks where both feet remain on the steps and body weight is centred.
- Maximum load: 160KG – includes operator body weight + all tools, parts, equipment, and any applied forces/torque. Never exceed this limit.

PRE-USE PREPARATION

1. Place the creeper on a flat, level, clean, dry, and unobstructed concrete or hard floor surface capable of supporting the total load.
2. Ensure the rear casters are unlocked so the unit can be positioned easily.
3. Roll the creeper into position under the vehicle engine bay or work area.
4. Apply brakes to rear casters before any adjustment or climbing.
5. Adjust the chest pad height and lean-in angle:
 - Use the ladder angle support to select the desired step/notch for the required angle.
 - Ensure the ladder angle support bar fully engages into the notch and is seated securely.
 - Test by gently applying weight—confirm no movement or slippage.

OPERATION

SAFE OPERATION

1. Face the creeper at all times.
2. Use both hands and maintain three points of contact when climbing up or down the steps.
3. Step onto the lowest rung first, then climb deliberately while keeping your body centred between the side rails.
4. Once at working height, gently lean your chest onto the padded deck. Do NOT jump, fall, sit, stand, kneel, or apply shock loads to the pad.
5. Keep movements slow and controlled. Do NOT overreach—reposition the creeper if needed.
6. Work only within arm's reach; avoid twisting or leaning far sideways.
7. Do NOT use over a running/hot engine, near moving parts, exhaust systems, live electrical components, or in wet/damp conditions.
8. Do NOT move the creeper while anyone is on it or while tools/parts are resting on it.
9. Descend facing the creeper, using both hands and three points of contact.

SHUT-DOWN / AFTER USE

1. Carefully step down from the creeper while maintaining three points of contact.
2. Remove any tools or parts.
3. Unlock rear casters only after dismounting.
4. Roll the creeper to storage location
5. Lock the rear casters once positioned for storage.

WARNING!

- Only one person at a time.
- Do NOT exceed 160KG total load.
- Do NOT use if damaged, worn, or if angle adjustment mechanism does not lock securely.
- Do NOT modify the creeper in any way.
- If the ladder angle support bar mechanism feels loose or fails to engage fully, stop use immediately and have it inspected/repaired by qualified personnel.

Follow these operating instructions precisely to prevent falls, tip-overs, collapses, or other serious injuries.

PREVENTATIVE MAINTENANCE

MAINTENANCE & CARE

Regular maintenance keeps your 160KG topside creeper safe, stable, and reliable. Perform these checks and procedures as outlined below. Failure to maintain the product properly may result in reduced performance, premature wear, or serious injury.

INSPECTION – BEFORE EVERY USE

Inspect the creeper thoroughly:

- Check all welds, frame members, and joints for cracks, bends, deformation, or corrosion.
- Ensure all bolts, nuts, and fasteners are present and tight (do not overtighten).
- Verify caster wheels spin freely, swivel smoothly, and lock/unlock properly.
- Confirm the height-adjustment mechanism (pins, slots, and bar) engages securely in all positions with no excessive play.
- Examine the chest pad for tears, excessive wear, or detachment from the frame.
- Check all warning labels and capacity plates are legible and securely attached. Do NOT use the creeper if any defect is found. Repair or replace damaged parts before operation.

PERIODIC INSPECTION (MONTHLY OR AFTER HEAVY USE)

In addition to daily checks:

- Tighten any loose hardware.
- Inspect adjustment mechanism for wear on pins, slots, or locking bar.
- Look for signs of fatigue or bending in the frame rails and cross-members.
- Test stability on level ground with full intended load (do not exceed 160KG). Replace worn or damaged components immediately with identical OEM parts.

CLEANING

- Wipe the frame with a damp cloth and mild detergent to remove grease, oil, or dirt. Dry thoroughly to prevent rust.
- Clean the chest pad using a mild upholstery cleaner (non-caustic, non-abrasive). Avoid harsh chemicals, solvents, or pressure washers.
- Do NOT immerse any part in water or use in wet environments.
- Keep labels clean and readable—replace if faded or damaged.

PREVENTATIVE MAINTENANCE cont.

LUBRICATION

DO NOT lubricate the casters, adjustment mechanism, or pivot points. Grease or oil can attract dirt, cause slippage, or damage plastic/locking components. The design is maintenance-free in these areas. If pivots become stiff due to contamination, clean only with a dry cloth or compressed air.

STORAGE

- Store indoors in a dry, covered area away from direct sunlight, moisture, or extreme temperatures.
- Fold the creeper fully and lock casters to prevent accidental movement.
- Avoid stacking heavy items on top.

SERVICE & REPAIRS

WARNING! Only qualified service personnel should perform repairs or modifications. Improper servicing can create serious hazards, including collapse, tip-over, or failure during use. Use only genuine replacement parts. Contact your supplier or manufacturer for parts, service advice, or replacement labels.

LABEL & PLATE MAINTENANCE

Keep all safety warnings, capacity plates, and instruction labels clean, legible, and in place. If any label becomes damaged, illegible, or missing, contact the manufacturer immediately for replacements before continued use.

Follow these guidelines to extend the life of your topside creeper and maintain safe operation. Retain this manual for reference.



STORAGE

STORAGE

Store the topside creeper vertically to save space.

1. Release the locking pins on both rear legs.
2. Lift/fold the legs upward into the storage position.
3. Secure the legs by re-inserting and locking the pins (see photos).
4. Position the creeper upright against a wall or in a designated area.
5. Lock the rear casters to prevent movement.

Store indoors in a dry location, away from children and heavy objects. Avoid outdoor exposure to weather.

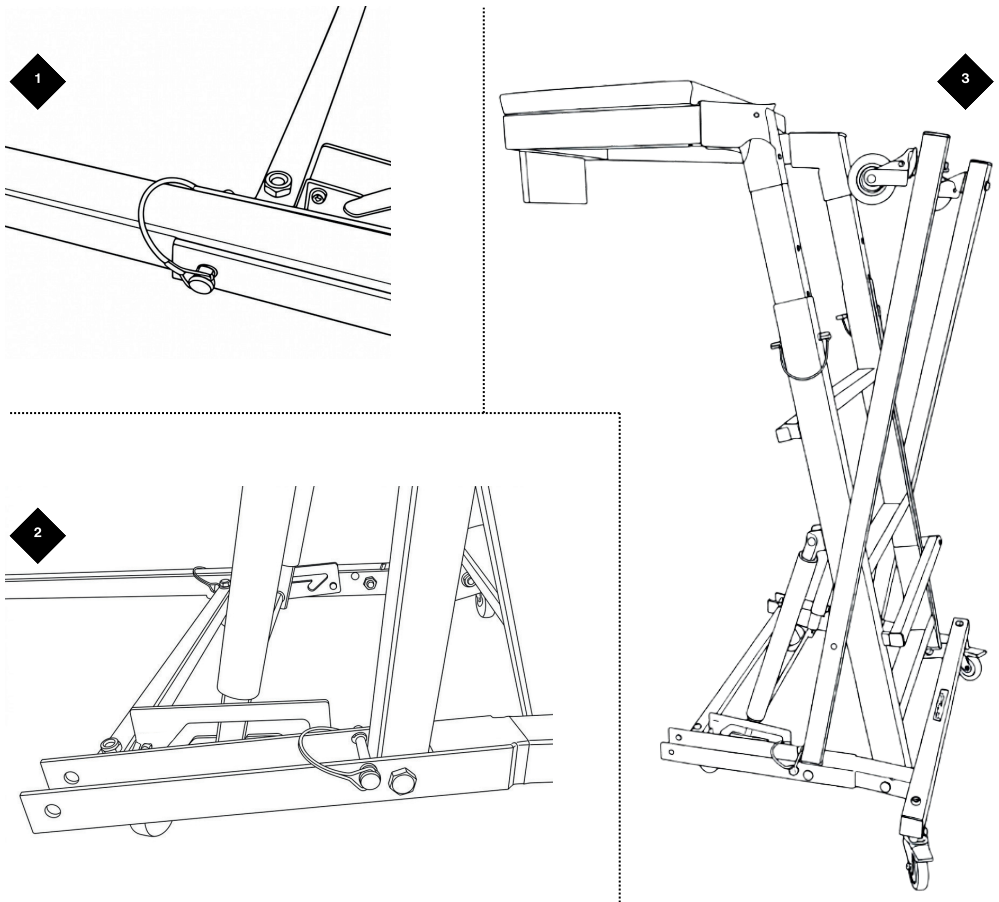

PARTS LIST

Number	Description	Qty
1	BASE FRAME	1
2	LEFT / RIGHT LEG	1 ea
3	REAR WHEELS (BRAKED)	2
4	D-SHAPED LOCKING PIN	4
5A	LADDER FRAME	1
5B	LADDER	1

Number	Description	Qty
6A	LEG CROSS SUPPORT	1
6B	LADDER ANGLE SUPPORT	1
7	FRONT WHEELS (45mm STEM)	1
8	HARDWARE KIT	1
9	CHEST DECK FRAME	1
10	POUCH	1

Number	Description	Qty
11	CENTRE WHEELS (35mm STEM)	1
12	ANGLE ADJUSTMENT BRACKET	2
13	CHEST DECK PAD	1
14	POUCH BRACKET	1
15	BUMPER PADS	2
16	PROTECTIVE BOOT	2

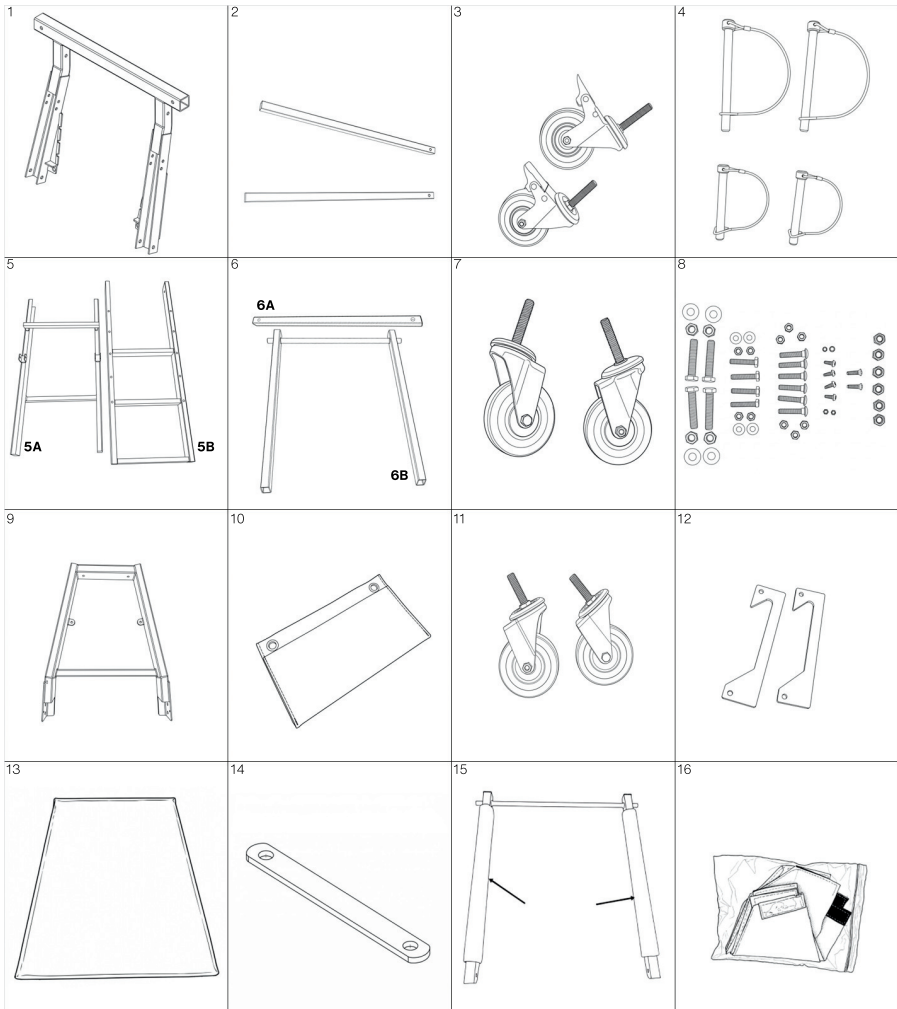

WARRANTY

Tradequip Product Warranty Information

All Tradequip products undergo thorough testing and quality assurance procedures prior to dispatch to ensure they are free from defects in materials and craftsmanship. A warranty is provided for a period of twelve months from the date of purchase. This warranty shall be void if the product is leased or hired out to third parties.

Warranty Claim Process

Should you experience any issues with your equipment, please return the complete product to your nearest authorized warranty repair agent or contact the TQB Brands Pty Ltd Warranty team at warranty@tqbbrands.com.au.

- If an inspection determines that the fault is due to defective materials or workmanship, repairs will be conducted at no cost to you.
- This warranty does not cover normal wear and tear or damages resulting from misuse, careless handling, unsafe practices, alterations, accidents, or repairs attempted by anyone other than an authorized TQB Brands Pty Ltd repair agent.

Important Notes

- This warranty supersedes any other expressed or implied guarantees, and modifications to its terms are not permitted.

Your TQB Brands Pty Ltd warranty is valid only if you can provide a dated receipt or invoice as proof of purchase within the 12-month period.

Consumer Guarantee Our goods come with a guarantee that cannot be excluded under the Australian Consumer Law. You are entitled to a replacement or refund for a major failure and compensation for any other reasonably foreseeable loss or damage. You are also entitled to have the goods repaired or replaced if the goods fail to be of acceptable quality and the failure does not amount to a major failure.





TQB Brands Pty Ltd

www.tqbbrands.com.au